

GENERAL SPECIFICATIONS

• L.O.A	14,60 m	47'11"
• Hull length	14,27 m	46'10"
• L.W.L.	13,86 m	45'6"
• Beam	4,74 m	15'7"
• Deep draught	2,17 m	7'1"
• Deep ballast weight	3 550 kg	7,826 lbs
• Shallow draught	1,83 m	6'
• Shallow ballast weight	4 060 kg	8,951 lbs
• Air draught	21,69 m	71'2"
• Light displacement	12 594 kg	27,765 lbs
• Fuel capacity (standard)	200 l	53 US Gal
• Fuel capacity (Optional equipment)	200 l	53 US Gal
• Fresh water capacity (standard)	370 l	98 US Gal
• Fresh water capacity (Optional equipment)	320 l	85 US Gal
• Engine power	75 HP POD 120	75 HP POD 120

ARCHITECT / DESIGNERS

- Naval Architect: Berret Racoupeau Yacht Design
- Interior design: Nauta Design

EC CERTIFICATE

- Category A - 11 persons
- Category B - 12 persons
- Category C - 14 persons

STANDARD SAIL LAYOUT AND AREA

• Mainsail (classic)	56,00 m ²	603 sq ft
• Genoa (105 %)	56,00 m ²	603 sq ft
• Asymmetrical spinnaker	130,00 m ²	1,400 sq ft
• I	18,75 m	61'6"
• J	6,06 m	19'11"
• P	17,09 m	56'1"
• E	5,55 m	18'3"

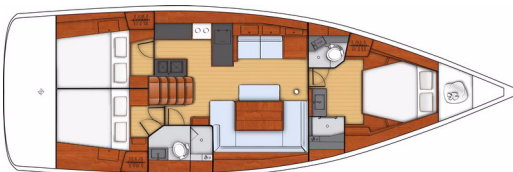

3 cabins - 2 head compartments

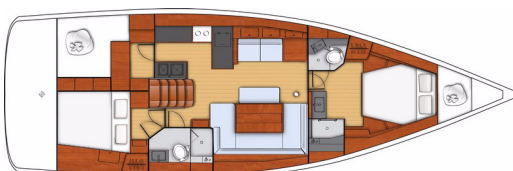

2 cabins - 2 head compartments



STANDARD EQUIPMENT

CONSTRUCTION

- Design in accordance with European Directive requirements and according to EC certification
- Monolithic hull design in polyester
- Monolithic structural inner moulding bonded to the hull
- Injection moulded deck in glass fibre/balsa sandwich, covered with «diamond-point» non-slip coating
- Deck hull joint screwed, bonded and banded with 1 solid wood bulwark
- Cast iron keel fixed with bolts and stainless steel backing plates
- Rudder hung with glass compound stock
- White coloured hull - Grey metal hull graphics

DECK EQUIPMENT

RIGGING

- Standard mast 9/10 anodized aluminium installed on the deck, 2 aft-swept spreaders
- Anodised aluminium boom
- Discontinuous stainless steel standing rigging
- 2 Backstays with bottlescrews
- Rigid boom vang with tackle
- Genoa furling system with drum on the deck
- 2 Blocks Stand Up on mainsheet arch
- 2 genoa tracks with piston adjusted traveller cars
- 2 Genoa sheet return blocks
- Rigging run back to cockpit (except boom topping lift)
- Complete running rigging: Main halyard, genoa halyard with clutch on mast and cleat, Boom topping lift with cleat on mast, Mainsheet, 2 Genoa sheets 2 rapid reefing lines, 1 manual reef
- 8 Jammers
- 2 halyard bags

WINCHES

- 2 Self-tailing genoa sheet winches (H60.2 STC)
- 2 Self tailing coachroof winches (H46.2 STC)
- 2 Aluminium winch handles Speed Grip
- 2 Winch handle boxes

SAILS

- Furling genoa with UV protective strip
- Semi full batten written sail with slider and roller slider
- System: Lazy Jack and Lazy Bag in Natural colour

MOORING LINES - MOORING

- Self-bailing chain locker - Clench bolt - Hatch cover
- Stainless steel bow fitting 2 rollers
- 12 V - 1500 W Vertical electrical windlass - Remote control
- 6 Aluminium mooring cleats - Stainless steel deck line protection

SAIL LOCKER

- Access through deck hatch T60
- Stainless steel ladder
- Shelving

SAFETY ON DECK

- 1 Open stainless steel forward pulpit
- 2 Stainless steel aft pushpits
- 1 Lifebuoy support bracket
- 1 Outboard engine bracket
- Ring for flag welded on balcony
- Double guardrail and stainless steel stanchions - Opening to port and to starboard in guardrail

COCKPIT

- Self-draining cockpit
- 2 Cockpit locker
- 2 Lockers in cockpit sole beneath helm's feet
- 1 Liferaft locker under helm seat (0,80 m x 0,40 m x 0,58 m / 2'7" x 1'4" x 1'4")
- 1 Gas locker for bottle(s) under the port helm seat
- Natural solid wood slatted cockpit benches
- 2 Steering wheel consoles: Stainless steel steering wheels - 900 mm diameter - leather covered - Steering gear at the helm station - metal cable transmission system - Stainless steel handrail - navigation instrument support (optional instruments) - Glass holder
- 1 Deck hole for access to tiller system + Power supply access hatch
- 1 Tiller
- 2 Steering compass on binacCLE
- Portside engine control and control panel
- Polyester cockpit table - 2 flaps - oddments locker - 2 Large storage space - Stainless steel handrail - 12 V socket - lamp with shade
- Cold water cockpit shower hose
- 1 Fixed composite arch - Built-in lighting
- 1 Shore power socket to port
- 2 Hinged PMMA companionway doors - Sliding hatch made of PMMA

SWIM DECK / STERN DECK

- Fully opening transom, convertible to bathing platform (2,85 m x 0,77 m / 9'4" x 2'6")
- Electrically controlled opening
- Natural solid wood decking on sun deck
- 1 Stainless steel swim/boarding ladder - solid wood steps - folding

INTERIOR

- Woodwork Alpi Mahogany
- Parquet type laminated floors
- Fabric hull linings in saloon and cabins (White)
- Fabric upholstery
- Marine mattresses in the cabins

COMPANIONWAY

- Headroom: 1,98 m / 6'6"
- Wooden saloon companionway with moulded wood suspended steps with non-slip surface
- 2 Leather covered stainless steel handrails

SALOON

- Headroom: 1,98 m / 6'6"
- U shaped saloon bench - double density foam
- Seating on pantograph
- Saloon table in 1 piece - Varnished wood top with inlay - Aluminium legs
- Mirror on bulkhead
- Cupboards - Shelves and stowage along the hull - Storage under bench seats
- Shelves with stainless steel fiddles
- 2 Panoramic deck house windows with concertina blinds
- 2 Hull portholes with curtain
- 2 Opening portholes on coaming in side windows
- 1 Opening deck hatch with blind / Mosquito net

CHART TABLE - PORT SIDE

- Sliding, can be configured with the armchairs - Placed against the forward bulkhead, against the galley or between the 2 mobile seats
- Table with flap - Moulded wood fiddle
- Switch panel on bulkhead for access to electrical functions
- Navigation instrument panel (without instruments)
- 1 Reading light



GALLEY - PORT SIDE

- Headroom: 1,90 m / 6'3"
- L-shaped galley with separate sink located below companionway
- Compact grey laminated worktop
- 1 Stainless steel sink 2 rectangular basins - 1 Mixer tap with hot/cold water under pressure
- 1 Gas cooker 2 burners - Stainless steel oven on mountings - Stainless steel protection handrail
- 1 12 V 100 litre ice box / 26 US Gal, top opening
- 1 12 V 130 litre refrigerator / 34 US Gal, front opening
- Fitted lockers and closed shelving (Shelving, Bin)
- 1 Base cabinet: 1 Drawer - 2 shelves
- Storage space along the hull
- 2 Opening ports on coaming with curtains on side windows

FORWARD CABIN

- Headroom: 1,92 m / 6'4"
- Central double bed (2,09 m x 1,55 m x 1,18 m / 6'10" x 5'1" x 3'10")
- Hanger closets - Valet tray - Cubby hole locker - Base cabinet - Storage space under bed
- 2 flush deck hatches with blinds / Mosquito net
- 2 Hull portholes with curtain

FORE WASHROOM

Completely built in to the cabin with:

TO STARBOARD

- Moulded basin in grey work surface, Faucet
- 1 Bathroom storage cabinet
- 1 Mirror
- 1 Glass shower cabin with flush access and stowage on the bulkhead
- 1 flush deck hatch with blind / Mosquito net

TO PORT

- Separate WC
- Hand basin
- Storage space along the hull
- 1 flush deck hatch with blind / Mosquito net

STARBOARD AFT HEAD COMPARTMENT

- Headroom: 1,92 m / 6'4"
- Access through saloon and the starboard aft cabin
- Separate shower - 1 Faucet - Stowage on bulkhead
- 1 Manual marine toilet
- 1 Rigid holding tank 64L / 17 US Gal
- Basin - 1 Faucet
- 2 Mirrors
- Toilet accessories
- 1 Opening portlight with curtains in side windows in the coaming

STARBOARD AFT CABIN

- Headroom: 1,86 m / 6'1"
- 1 Double bed (2,09 m x 1,18 m x 1,55 m / 6'10" x 3'10" x 5'1")
- Access door to starboard aft washroom
- Cupboards, Hanging locker, Closed shelving, Stowage on both sides of berth
- 1 Large size hull port with curtain
- 1 Opening deck hatch with blind / Mosquito net
- 1 Opening cockpit port with curtain
- 1 Glazing on companionway bulkhead

Version 2 cabins, 2 head compartments

AFT-GALLEY - PORT SIDE

- Headroom: 1,90 m / 6'3"
- Closed galley aft, accessible through galley
- Cupboards, shelves
- Dedicated position for a 5 kg washer drier (optional)
- 1 Opening deck hatch with blind / Mosquito net
- Direct access to cockpit locker (Port side)

Version 3 cabins, 2 head compartments

PORT AFT CABIN

- Headroom: 1,86 m / 6'1"
- 1 Double bed (2,05 m x 1,35 m x 1,55 m / 6'9" x 4'5" x 5'1")
- Cupboards, Hanging locker, Closed shelving
- 1 Large size hull port with curtain
- 1 Opening deck hatch with blind / Mosquito net
- 1 Opening cockpit port with curtain
- 1 Glazing on companionway bulkhead

ENGINE

- Engine Yanmar Diesel 75 hp / 75 HP Sail Drive or POD 120 Dock & Go
- Engine control - Control panel in the port cockpit
- Engine compartment: Soundproofing foam - Ventilation: 1 air intake and 1 pressured air outlet
- 1 Alternator 12 V / 125 Ah (Dock & Go: 1 Alternator 12 V / 120 Ah)
- 1 Rotomoulded diesel tank 200 L / 53 US Gal (under port aft berth) - Electronic gauge - Low level alarm - 1 Deck filler
- Filters: Sea water - Diesel - Decanter
- Fixed three blades propeller
- 1 Engine access through companionway (opening with 2 gas struts) - 2 Engine access through aft cabins

ELECTRICITY

- 12 V circuit
- 2 service batteries (140 Ah) - 1 Engine battery (110 Ah)
- 1 Power distributor
- 12 V Electrical panel (Fuses - Voltmeter - Water gauge - Fuel gauge - Battery warning - Fuel warning - Water warning)
- 1 12 V Sockets
- Lighting: Overhead lights - Reading lights - White striplighting
- Navigation lights: 1 Forward and aft navigation lights - 1 Engine navigation light / Spreader light forward of mast - 1 Anchor light on masthead
- Wire runs for options cables
- Full 220 V system (Interior sockets 220 V, 40 Amperes battery charger, Shore power socket)

PLUMBING

- 1 rotomoulded freshwater tank (330 l / 87 US Gal Forward cabin) - 2 Deck fillers - Separate tank filling - Tank selection with ¼ by-pass valves
- Pressurised electric water pump - Expansion tank - Inline filter
- 40 L Electric water heater / 11 US Gal (engine run)
- 1 Rigid holding tank 64L / 17 US Gal
- Delayed shower draining and electric shower drain pumps
- 1 Electric bilge pump - 1 Manual bilge pump
- 1 Electric ice box drain pump

GAS

- 1 Gas bottle box in the cockpit (Diameter 0,34 m x 0,53 m / 1'1" x 1'9")
- Regulator and safety tap



TRIM LEVEL

	ESSENTIAL	EXCLUSIVE
• B&G Electronic: Helm consoles to port and starboard - 1 T41 Graphic display	■	■
• B&G Electronic: Sensor (Loch, Speedometer, Temperature)	■	■
• B&G Electronic: Wind Sensor (Windvane, Anemometer)	■	■
• Hot/cold water cockpit shower hose	■	■
• Hifi: Fusion + Interior loudspeakers & Waterproof exterior speakers	■	■
• LED interior lights	■	■
• 2 140 amperes additional service batteries + 1 40 Amperes battery charger additional	■	■
• 1 Port electric coachroof winch - H46.2 STAECH		■
• Galley: Top opening 12 V cool box in ice box (Freezer)		■
• Storage space(s) under the floor		■
• Saloon and Cabins: Indirect lighting LED		■
• Stainless steel beading for fenders in cockpit locker		■
• LED: Navigation lights		■

PACKS

ELECTRONIC B&G PACK

A Pack

- Steering consoles: 2 Zeus 7" wide multifunction touch screens (GPS, Chart plotter, Chart reader - Cartography Navionics Silver included)

B Pack

- Swivel base on reverse side of cockpit table
- Multifunction touchscreen B&G Zeus 12" wide(GPS, Chart plotter, Chart reader - Cartography Navionics Silver included)

PERFORMANCE PACK

- Performance Incidence Sails (D4)
- German system (Two-way mainsheet at the helm station)

DOCK & GO VERSION

- YANMAR Diesel Dock & Go POD 60 engine
- Swivel Saildrive base
- skyhook
- Vessel Management Unit (VMU)
- Bow thruster
- Auto pilot



OPTIONS

Navigation electronics: B&G

- Wifi interface
- 4G Radar
- AC 42 autopilot + Control at steering station
- Chart table: Zeus 7" wide additional multifunction screen
- Chart table: Fixed B&G+V50 VHF, function AIS receiver + H50 cockpit handset
- WR 10 Wireless autopilot remote control
- AIS 400
- Forward Scan Sensor (underwater vision Forward)

Rigging - Sails

- Anodized mast furling system with Dacron mainsail
- Asymmetrical spinnaker rigging + Code 0 Rigging
- Self-tacking jib hardware
- Asymmetrical spinnaker
- Code 0 on "Top Down" furling system
- Tacking jib (replacing genoa)
- self-tacking staysail with manual furling + Fixed forestay
- Additional bow roller - Stainless steel bobstay
- Releasable forestay chainplate
- Backstays with bottlescrews (Adjustable)*
- Genoa sheet track leads adjustable from the cockpit
- 2 flag halyards

** Except on mast with in-mast furling*

Winches

- 2 Electric genoa sheet winches H 60.2 STCEH

Hull - Deck - Cockpit

- Grey "Perle" hull
- Blue-grey hull
- Cockpit sole natural solid wood
- Solid wood slatted catwalks
- Polyester/wood cockpit table + White PVC protective covers
- Silver Coachroof sprayhood
- Silver Cockpit Bimini
- Luxe coachroof sprayhood , Cadet Grey
- Cockpit bimini Luxe, Cadet Grey
- Complete cockpit closing Luxe, Cadet Grey
- White PVC steering wheel covers
- Covers pack Luxe (Table + Steering consoles), Cadet Grey
- Dark Narval Cockpit cushions + Carbon Sky backrests
- Bow thruster
- Refrigerated ice-box in cockpit table (30 L / 8 US Gal) - Positive cold
- 3 retractable blades propeller
- Stainless steel arch with davits
- White composite steering wheels
- Moorings lines, Mooring, Fenders
- Mooring cleats (stern deck)
- Windlass control in cockpit with chain counter
- Gangway ladders
- 4 Underwater projectors
- Shore freshwater supply
- Windex Windvane



BENETEAU

Oceanis 48

General Equipment list - Europe

Interior equipment

- Interior woodwork: Alpi satin light oak
- Luxe folding saloon table (double berth compatible)
- Interior upholstery, according to swatches: Fabrics, Leather, Ultraleather
- Upholstery padding (Saloon and Cabins): Anthracite Grey or Taupe lacquered
- TV LCD 24" + DVD player in the saloon
- Stainless steel 3 burner oven/grill cooker on Luxe mounting
- 220V Microwave oven
- Dishwasher
- Sandblasted finish shower screen, Forward cabin (In place of standard)
- Double berth in saloon
- Slat mattresses
- Additional holding tank
- Quiet Flush electric toilet
- Mosquito nets
- Galley: Sea water/fresh water foot pump
- Extra water tank (2 x 160 l / 2 x 42 US Gal)
- Additional diesel tank (200 l / 2 x 53 US Gal)

- 12/220 V, 2 kVA converter
- 6 KVA 220 V / 50 Hz Generator - with cocoon
- Forced air heating fuel
- 220 V / 50 Hz Air conditioning
- Water maker 60 l / 16 US Gal/h